

**Legend**

- Boundary Lines**
- Yuba County Airport
  - Cities
  - City Sphere of Influence
  - County Line
  - Highway
  - Runway (6,006' length)
  - Future Runway Extension (994' length)
  - Parcels
  - River
- ALUC Policy Boundaries**
- Review Area 1
  - Review Area 2
- Overflight Zones**
- Approach Area - Avigation Easement Dedication
  - Primary Overflight Area - Recorded Overflight Notification and Real Estate Disclosure Statement
  - Airport Influence Area - Real Estate Disclosure Statement

**Notes**

1. See Section 3.4 and Policy 4.1.5 for applicable policies.
2. Avigation easement dedication is required for projects situated within the approach area defined by the following:
  - a) All locations within the CNEL 60 dB contour depicted on Map 2.
  - b) All locations within Safety Zones 1 through 5 as depicted on Map 3.
  - c) All locations beneath the approach (inner segment only) or transitional surfaces as depicted on Map 4.
3. Recorded overflight notification is required for residential development within the primary overflight area.
4. Real estate disclosure statements are recommended for new residential development within the remainder of the airport influence area.



**Yuba County Airport  
Land Use Compatibility Plan  
(Adopted March 2011)**

Map 5

**Compatibility Policy Map:  
Overflight**

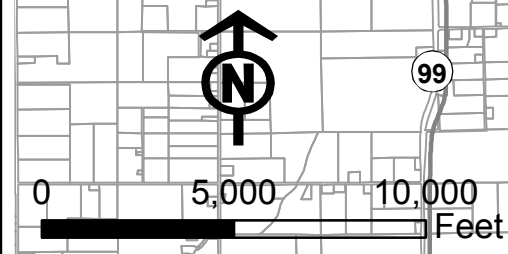

Base Map Source: Yuba County Planning Department